

QPD4-800-2500

4-Way, 0.8~2.5GHz

Features:

- * Small Size
- * Low Insertion Loss

Applications:

- * Amplifiers
- * Mixers
- * Antennas
- * Laboratory Test

Electrical

| | |
|--------------------|---------------------------------|
| Frequency: | 0.8~2.5GHz |
| Insertion Loss: | 0.6dB max. |
| Input VSWR: | 1.2 max. |
| Output VSWR: | 1.2 max. |
| Isolation: | 20dB min. |
| Amplitude Balance: | ±0.3dB |
| Phase Balance: | ±4° |
| Impedance: | 50Ω |
| Average Power: | 30W max. 2W max. as combiner |

Mechanical

| | |
|-------------|-----------------------------------|
| Size*1: | 50*56*12mm 1.969*2.205*0.472in |
| Connectors: | SMA Female |
| Mounting: | 4-Φ2.8mm through-hole |

[1] Exclude connectors.

Environmental

| | |
|------------------------|-----------|
| Operation Temperature: | -45~+85°C |
|------------------------|-----------|

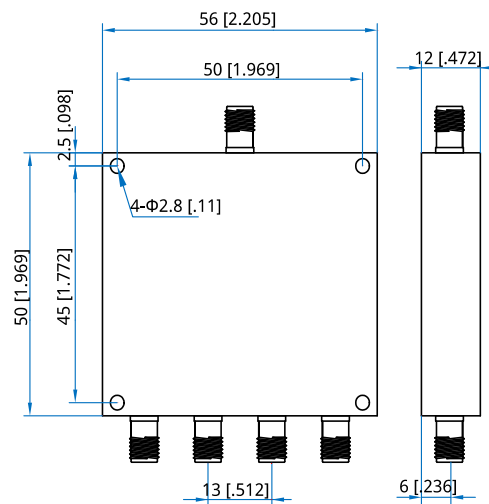
Outline Drawings

Unit: mm [in]

Tolerance: ±0.5mm [±0.02in]

How To Order

QPD4-800-2500

Customization is available upon request.